

APPLICATION:

PRODUCT NAME:  
**SINGLE DECK KETTLE FILLER**

JOB NAME:

SPECIAL CONFIGURATION  
 CHECK BASE MODEL AND OPTIONS

QUANTITY:

ITEM NO.

MODEL:  
 2178 WITH 6" SWING SPOUT  
 2186 WITH 8" SWING SPOUT  
 2194 WITH 10" SWING SPOUT  
 2208 WITH 12" SWING SPOUT  
 2216 WITH 14" SWING SPOUT  
 2224 WITH 16" SWING SPOUT

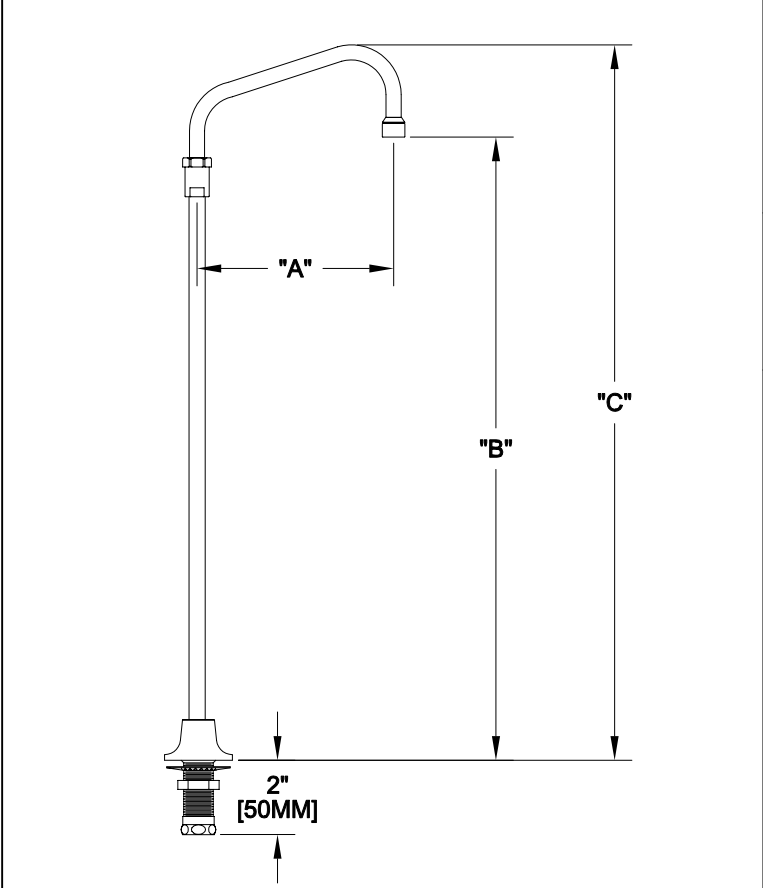

OPTIONS OR MODIFICATIONS:  
 SUPPLY LINES (24" OR 36") CIRCLE LENGTH  
 VANDAL RESISTANT KIT  
 OTHER \_\_\_\_\_

**FEATURES**

- \* SINGLE DECK RIGID BASE
- \* 1/2" MALE INLET
- \* 1/2" SLIP JOINT

**SYSTEM LIMITS**

- \* TEMP: 40°F MIN. TO 140°F MAX.
- \* PRESSURE 200 PSI MAX. STATIC
- \* 2.20 GPM AT 80 PSI

**SHIPPING WEIGHT**

- \* 5.0 LBS

MODEL	DIM "A"	DIM "B"	DIM "C"
2178	6" [150MM]	23" [584MM]	26-5/8" [676MM]
2186	8" [200MM]	23-1/4" [590MM]	27-1/8" [689MM]
2194	10" [250MM]	23-7/8" [606MM]	27-5/8" [701MM]
2208	12" [300MM]	24-1/2" [622MM]	28-1/8" [714MM]
2216	14" [350MM]	25-1/8" [638MM]	29" [736MM]
2224	16" [400MM]	25-7/8" [657MM]	29-5/8" [752MM]

ROUGH-IN:

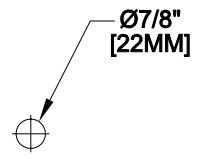

ANSI/A112.18.1M

**FISHER**  
 FISHER MANUFACTURING COMPANY  
 TOLL FREE: 800-421-6162 - FAX: 800-832-8238  
 information@fisher-mfg.com - www.fisher-mfg.com