

Replacement Parts List

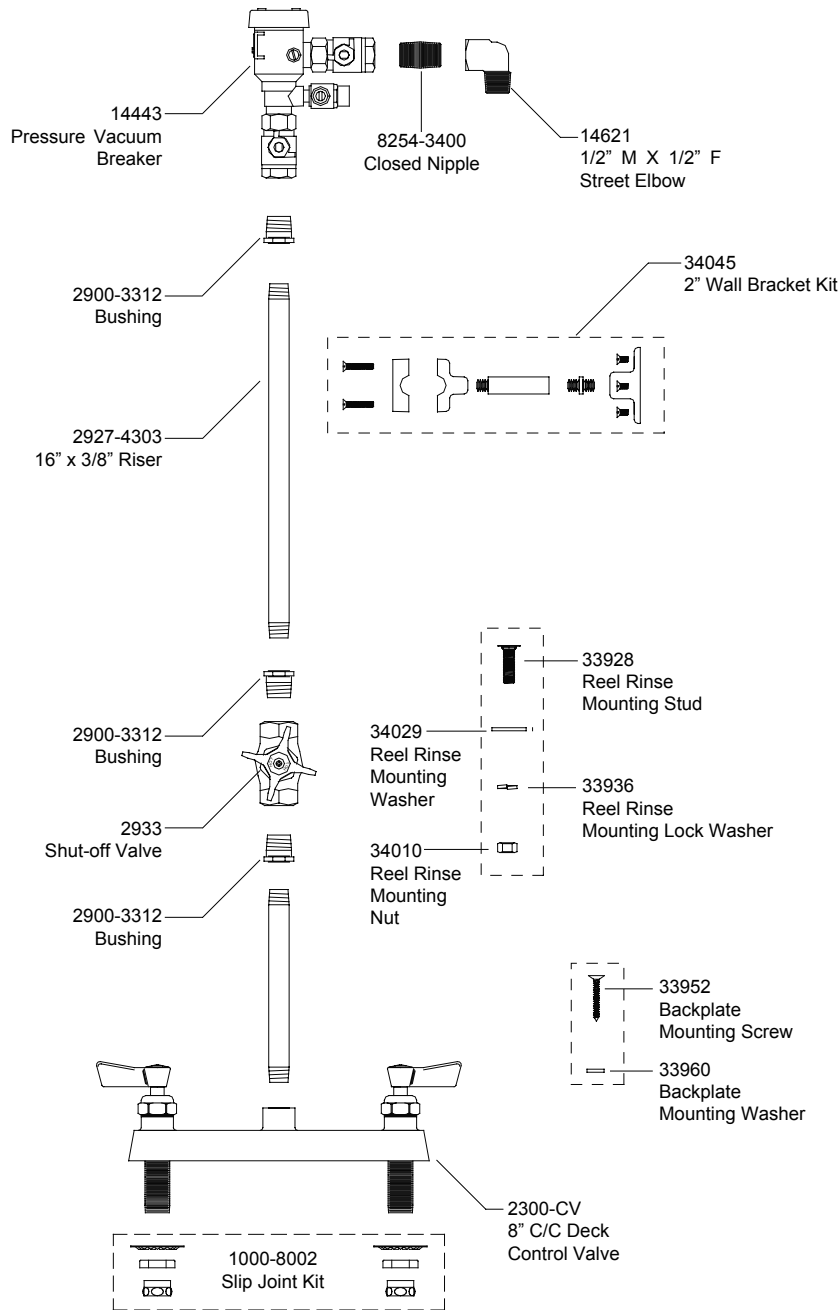

FISHER
 MANUFACTURING COMPANY
 PO BOX 60, TULARE, CA 93275
 (800)421-6162, FAX: (800)832-8238
 www.fisher-mfg.com

PART NO. 34037

REV. A

FISHER
 FISHER MANUFACTURING COMPANY

Stainless Steel Reel Rinse Back Plate Product Installation Guide

Since 1936, Fisher Manufacturing Company has manufactured heavy-duty, high quality plumbing products and hardware specialties for the food service industry. For three generations, the Fisher family has adhered to a strict dedication of and overall value. When you install Fisher products... you install the best. Our hardware is manufactured with the standardization of internal mechanisms. All chrome plating is triple plated copper, nickel and chrome for durability. Every piece of equipment we make is rigorously tested in both our modern in-house testing center and in actual field situations under extreme conditions. Every detail is thoroughly checked. Before we make our products available to you, they pass each and every test. You get proven performance. Guaranteed.

Limited One Year Warranty

Fisher Manufacturing Company warrants its products and parts thereof (except as noted below) against defects in materials or workmanship for a period of one year after the date of original purchase. During this period Fisher Manufacturing Company will replace a defective product or part without charge to you, provided that the entire product is delivered to Fisher Manufacturing Company. All transportation and insurance charges for shipping the product to and from Fisher Manufacturing Company must be borne by you. Charges for transportation and insurance may, at the option of Fisher Manufacturing Company, be refunded depending upon our investigation of the warranty claim. This warranty does not cover external finish (except at date of original purchase) or labor costs not specifically authorized by Fisher Manufacturing Company.

A full and complete copy of our One Year limited warranty is available upon request.

WARNING:

Proposition 65 requires that we provide you with the following notice: "This product Contains A Chemical Known To The State Of California To Cause Birth Defects Or Other Reproductive Harm."



#29688 - Stainless Steel Reel Rinse Back Plate

KEEP THIS MANUAL FOR FUTURE REFERENCE



ANSI/A112.18.1M, ANSI/NSF 61.9

FISHER MANUFACTURING COMPANY - TOLL FREE: 800-421-6162 FAX: 800-832-8238

www.fisher-mfg.com

Installation Instructions for SS Reel Rinse Back Plate

BE SURE TO CHECK WITH YOUR LOCAL DEPARTMENT HAVING JURISDICTION REGARDING BACKFLOW PREVENTION

Installation Notes:

- Be sure to shut off water supply before beginning.
- Use pipe thread sealant such as PST on all threaded joints.
- Check the packaging for missing items BEFORE beginning installation. If items are missing, contact your supplier.

Tools Required for Installation

- Hammer
- Ratchet or Wrench, 9/16
- Large Phillips Screw Driver
- Drill with 9/64" Drill Bit
- Thread Sealant or Teflon Tape



Installation Instructions:

Installing the Reel Rinse Mounting Studs

The Wall Back Plate is designed to work with any Fisher Manufacturing Company provided reel rinse unit. Because there are multiple hole patterns associated with the reel rinse line, the mounting studs are provided loose and each hole pattern is drilled into the stainless steel back plate. Depending on what model you have will determine which hole pattern you use for the mounting studs. See below for installation.

1. Unpack Back Plate and remove from wooden crate.

For Reel Rinse models 29599, 29262, 29610, 29602, 29637, 29629, 29653, 29645

2. Find hole pattern "A".
3. From behind the back plate, insert the studs into the holes associated with hole pattern "A".
4. Hammer bolts in place until bolts are secured.

For Reel Rinse models 2980, 2985

2. Find hole pattern "B".
3. From behind the back plate, insert the studs into the holes associated with hole pattern "B".
4. Hammer bolts in place until bolts are secured.

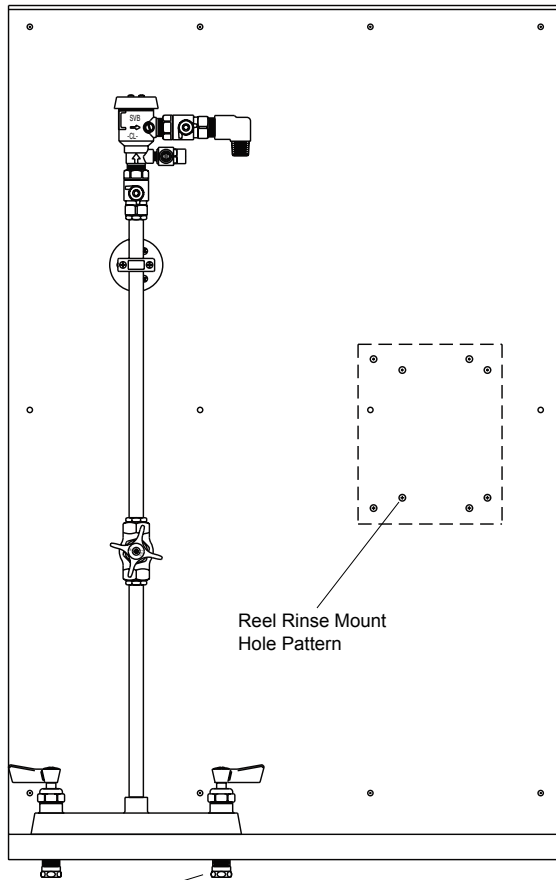

Back Plate Inlets

Figure 1, Wall Back Plate

Installation Instructions Continued

It is highly recommended that at least 2 people are involved in this installation as the Reel Rinse Back Plate is very heavy.

5. Using the reoccurring hole pattern in Figure 3, mark and drill twelve – 9/64" pilot holes.

NOTE: BECAUSE THE MOUNTING SCREWS WILL BE SUBJECTED TO EXTREMELY HIGH LOADS, THE MOUNTING SCREWS MUST ENGAGE THE WALL STRUCTURE

6. Using the 12 provided wall mounting screws, mount the Back Plate onto the mounting surface.
7. Using the provided reel mounting nut, washer and lock-washer, mount the reel rinse unit on the mounting studs.
8. Using the appropriate adapter, thread sealant or Teflon tape, connect the Reel Rinse lead-in line to the 1/2" male elbow outlet of the Back Plate.
9. Using thread sealant or Teflon tape, connect the water supply lines (not included) to the Back plate inlets. (See Figure 1)
10. Flush water through the system and check for leaks.

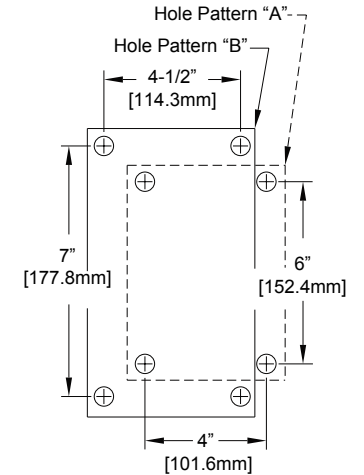

Figure 2, Hole Patterns

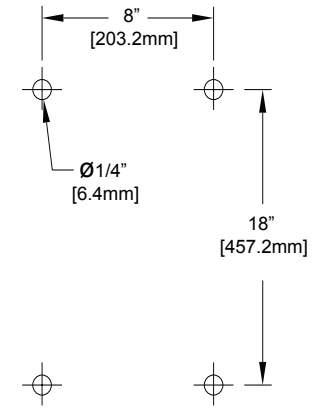

Figure 3, Re-occurring Mounting Hole Pattern 3-rows x 4 columns